



# HT 103 CHIMNEY

Double-wall stainless steel all fuel system

---

# JEREMIAS INTERNATIONAL

---

## 40 YEARS OF EXPERIENCE

Founded by a German Chimney sweep and still family owned, the Jeremias Group has grown into the world leader in engineered and manufactured flue and chimney systems. Covering domestic, commercial and industrial exhaust applications, Jeremias Group product ranges include over one hundred (100) different CE or UL certified systems, complemented by freestanding industrial steel chimneys up to 10 feet in diameter. Jeremias matches the industry's highest quality product offering with unmatched engineering and technical expertise, solving your most challenging applications.

With over 40 years of history, Jeremias continues to grow our global footprint while remaining true to our values. With seven (7) manufacturing plants in six (6) different countries worldwide, the Jeremias Group today has more than 1,000 employees. Servicing North America across residential, commercial and industrial segments, Jeremias USA is headquartered and operates its industry leading manufacturing facility just outside of Atlanta, GA.

## RESEARCH AND DEVELOPMENT

Innovation and continuous improvement are central to the Jeremias success story. The Jeremias Group operates test facilities around the globe to support new and improved products, partnering closely with customers and test agencies to deliver superior safety and performance. Jeremias USA has invested in the latest technology and grown its R&D presence, expanding our facility in Logan, Ohio. Complementing our R&D test facilities, Jeremias Group experts participate in global advisory roles, sitting on critical industry and product code review panels, shaping the industry in the years ahead.







---

# JEREMIAS CONTENTS

---

Introduction	Page 2
Technical specifications	Page 4
System components	Page 5
Warranty statement	Page 13



# JEREMIAS HT 103 CHIMNEY

## CHIMNEY LIKE YOU'VE NEVER SEEN IT BEFORE

### PRODUCT - 103HT CHIMNEY - "ALL FUEL, CLASS A, FACTORY BUILT CHIMNEY"

- DWHT is North America's premier solid fuel chimney. Born from Jeremias's world renowned Commercial and Industrial product offerings, DWHT brings decades of proven history in the most punishing environments.
- Superior inner wall construction:
  - Utilizing 316L/444 stainless steel, uniquely capable of withstanding highly corrosive environments together with extreme temperatures.
  - Fully welded seams (never cheap lock seams or overlap weld)!
  - The longest joint overlap in the industry (2.2"), providing maximum strength and protection
  - The thickest inner wall material offered (0.020"), +20% more than competitors consistent with Industrial performance!
- DWHT uses a unique and revolutionary product design, with separate inner and outer wall construction, held together only with high temperature insulation (no spacers, rings, etc!). This design eliminates any "thermal bridge" (a design constraint plaguing all other offerings) between inner and outer walls, minimizing thermal transfer.
- DWHT utilizes only solid block or blanket type insulation, never cheap loose fill fiber. Rest assured, there are no voids, no insulation settling, and no unseen "hot spots"!

### CUT TO LENGTH IN THE FIELD



- DWHT's pipe construction allows unmatched installation flexibility, the only UL listed system with all pipes capable of being cut to any length (if needed).

Each pipe not only has the industry's longest joint overlap, but the strongest locking band to deliver maximum strength together with minimum thermal transfer.



# SYSTEM COMPONENTS



HT 103 CHIMNEYS

## CHIMNEY LENGTH

Insulated Chimney Length. Includes locking band.

DESCRIPTION		A	B	C
ITEM (STANDARD)	ITEM (316L INNER)			
DWHT6-6L-SS 6" Chimney length SS 6"	DWHT6-6L-316 6" Chimney length 316 6"	6"	8"	6"
DWHT6-12L-SS 6" Chimney length SS 12"	DWHT6-12L-316 6" Chimney length 316 12"	6"	8"	12"
DWHT6-18L-SS 6" Chimney length SS 18"	DWHT6-18L-316 6" Chimney length 316 18"	6"	8"	18"
DWHT6-24L-SS 6" Chimney length SS 24"	DWHT6-24L-316 6" Chimney length 316 24"	6"	8"	24"
DWHT6-36L-SS 6" Chimney length SS 36"	DWHT6-36L-316 6" Chimney length 316 36"	6"	8"	36"
DWHT6-48L-SS 6" Chimney length SS 48"	DWHT6-48L-316 6" Chimney length 316 48"	6"	8"	48"
DWHT8-6L-SS 8" Chimney length SS 6"	DWHT8-6L-316 8" Chimney length 316 6"	8"	10"	6"
DWHT8-12L-SS 8" Chimney length SS 12"	DWHT8-12L-316 8" Chimney length 316 12"	8"	10"	12"
DWHT8-18L-SS 8" Chimney length SS 18"	DWHT8-18L-316 8" Chimney length 316 18"	8"	10"	18"
DWHT8-24L-SS 8" Chimney length SS 24"	DWHT8-24L-316 8" Chimney length 316 24"	8"	10"	24"
DWHT8-36L-SS 8" Chimney length SS 36"	DWHT8-36L-316 8" Chimney length 316 36"	8"	10"	36"
DWHT8-48L-SS 8" Chimney length SS 48"	DWHT8-48L-316 8" Chimney length 316 48"	8"	10"	48"

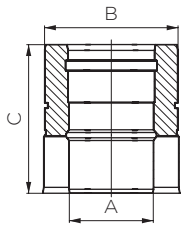

## 15 DEGREE ELBOW KIT

Used to offset chimney around obstacles. Each kit includes 2 elbows and an Elbow Strap for support. Includes 2 locking bands.

DESCRIPTION		A	B	C
ITEM (STANDARD)	ITEM (316L INNER)			
DWHT6-15ELKT-SS	DWHT6-15ELKT-316	6"	8"	3.7"
DWHT8-15ELKT-SS	DWHT8-15ELKT-316	8"	10"	3.8"

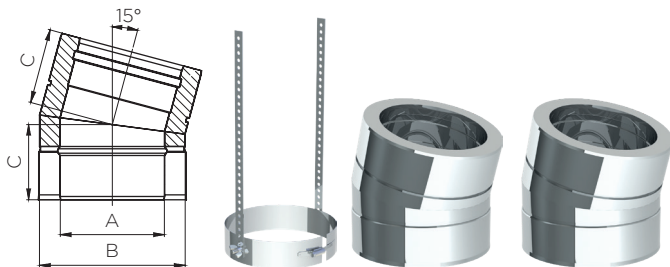

## 30 DEGREE ELBOW KIT

Used to offset chimney around obstacles. Each kit includes 2 elbows and an Elbow Strap for support. Includes 2 locking bands.

DESCRIPTION		A	B	C
ITEM (STANDARD)	ITEM (316L INNER)			
DWHT6-30ELKT-SS	DWHT6-30ELKT-316	6"	8"	4.2"
DWHT8-30ELKT-SS	DWHT8-30ELKT-316	8"	10"	4.5"



# SYSTEM COMPONENTS

HT 103 CHIMNEYS

## ACCESS TEE WITH CAP SS

Tee Connection with access door and removable insulated cap for inspection and cleaning. Includes 2 locking bands and a tee cap.

DESCRIPTION		A	B	C
ITEM (STANDARD)	ITEM (316L INNER)			
DWHT6-ATC-SS	DWHT6-ATC-316	6"	8"	16.8"
DWHT8-ATC-SS	DWHT8-ATC-316	8"	10"	16.8"

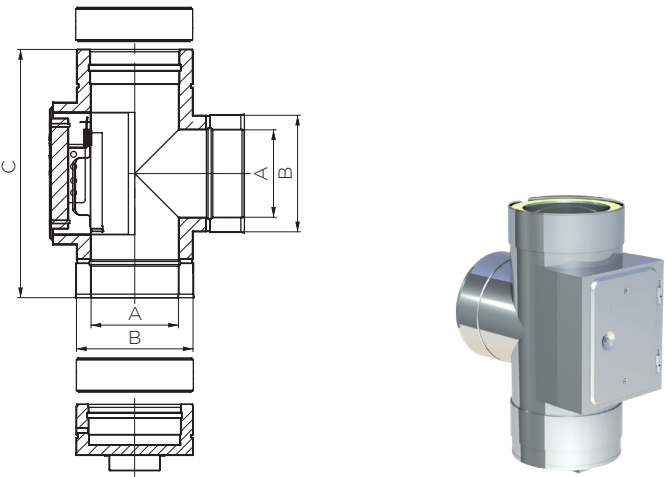

## TEE WITH CAP

Tee Connection with removable insulated cap for inspection and cleaning. Includes 2 locking bands.

DESCRIPTION		A	B	C	D
ITEM (STANDARD)	ITEM (316L INNER)				
DWHT6-TWC-SS	DWHT6-TWC-316	6"	8"	15"	9.5"
DWHT8-TWC-SS	DWHT8-TWC-316	8"	10"	15"	11.5"

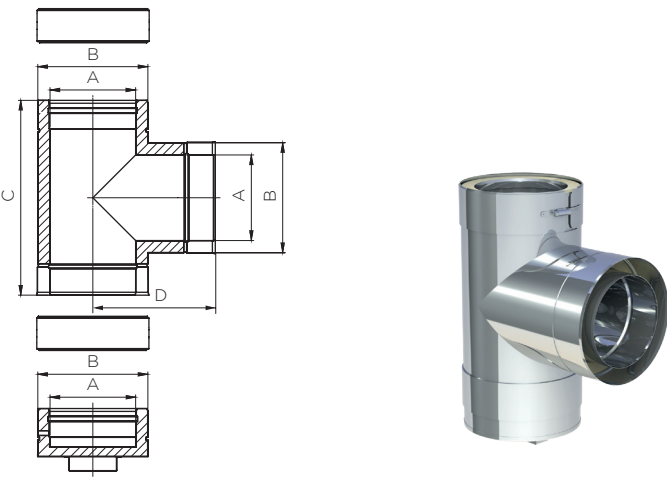

## WALL THIMBLE

Provides shielding and a finished look where HT Chimney passes through a wall. Thimble adjusts to accommodate wall up to 20" thick. Interior Cylinder and Trim Plate are Black powder coat.

DESCRIPTION	A	B
DWHT6-WT 6" Wall Thimble	6"	12"
DWHT8-WT 8" Wall Thimble	8"	14"

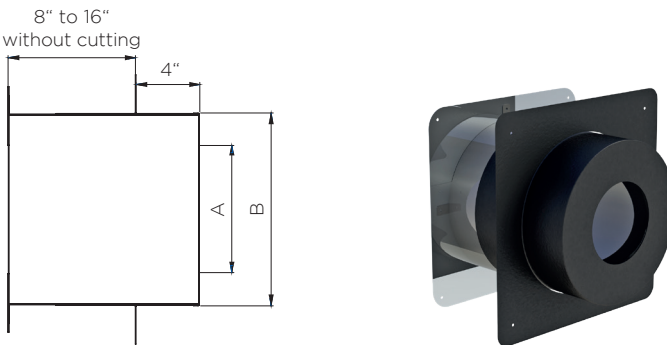

## SQUARE CEILING SUPPORT

Provides vertical support and a finished look where HT Chimney passes through a ceiling. Supports 44 ft. of chimney stack. The trim plate is adjustable to work on both flat and pitched ceilings. The Square support box and trim plates are black powder coat.

DESCRIPTION	A	B	C
DWHT6-CS36 6" Square Ceiling Support 36"	6"	12"	18"
DWHT8-CS36 8" Square Ceiling Support 36"	8"	14"	20"

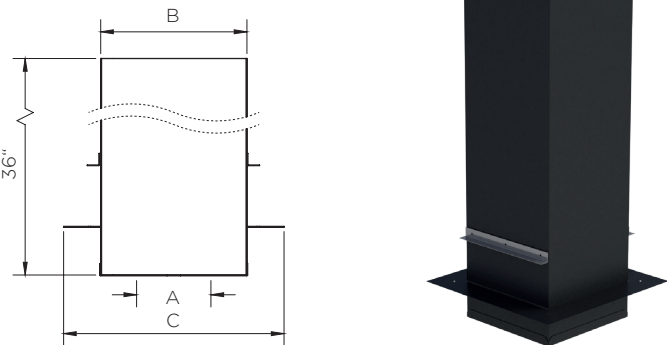



# SYSTEM COMPONENTS



HT 103 CHIMNEYS

## ROUND CEILING SUPPORT

Provides vertical support and a finished look where HT Chimney passes through a ceiling. Supports 44 ft. of chimney stack. Includes Trim Ring for flat ceiling installation. The Round Ceiling Support and Trim Ring are black powder coat. Two piece Round Support Trim rings (RST) included for pitched ceilings.

DESCRIPTION	A	B	C
DWHT6-CSR 6" Ceiling Support Round	6"	12"	17"
DWHT8-CSR 8" Ceiling Support Round	8"	14"	19"

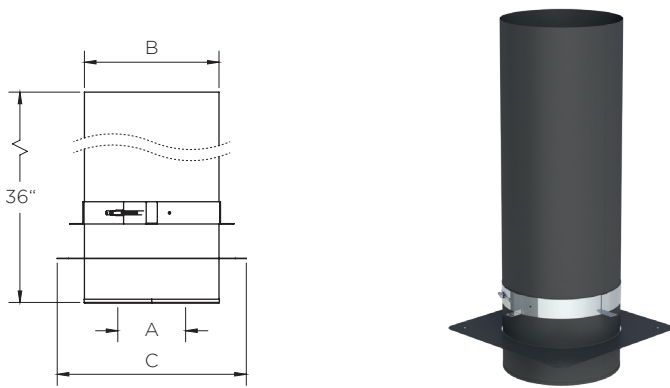

## ROOF SUPPORT

For supporting the chimney system from the exterior roof. Supports 12 ft. of chimney stack.

DESCRIPTION	A
DWHT6-RS-SS 6" Roof Support	8"
DWHT8-RS-SS 8" Roof Support	10"

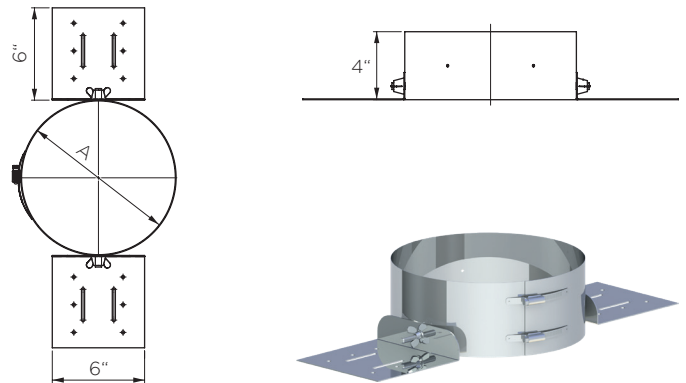

## CHIMNEY ADAPTER

Connects Smoke pipe to Jeremias HT Chimney. For use with Wall Thimble and Ceiling Support Box assemblies. Includes locking band.

DESCRIPTION		A	B	C	D	E
ITEM (STANDARD)	ITEM (316L INNER)					
DWHT6-AD775-SS	DWHT6-AD775-316	6"	8"	5.9"	7.7"	3.1"
DWHT8-AD775-SS	DWHT8-AD775-316	8"	10"	7.9"	7.7"	3.1"

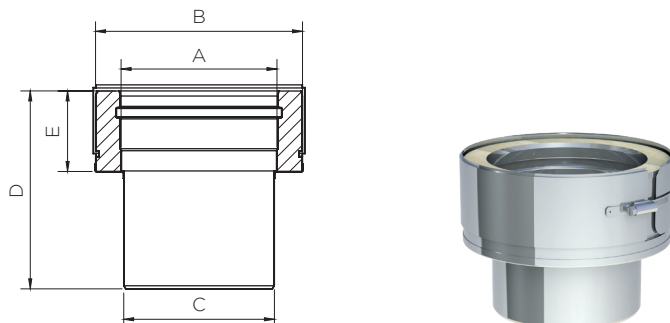

## ANCHOR PLATE

For transition from masonry chimney to 103HT Chimney.

DESCRIPTION		A	B	C	D
ITEM (STANDARD)	ITEM (316L INNER)				
DWHT6-AP-SS	DWHT6-AP-316	6"	8"	5.9"	10"
DWHT8-AP-SS	DWHT8-AP-316	8"	10"	7.9"	12"

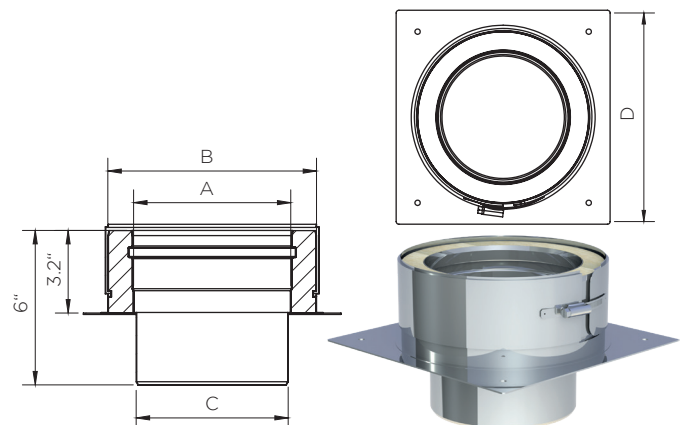

# SYSTEM COMPONENTS

HT 103 CHIMNEYS

## TEE SUPPORT

Provides vertical support for through-the-wall type installations. Supports 52 ft of chimney stack. The support plate includes a length of insulated HT Chimney. The support can be installed either above or below the Tee.

DESCRIPTION		A	B	C	D
ITEM (STANDARD)	ITEM (316L INNER)				
DWHT6-TS6-SS	DWHT6-TS6-316	6"	8"	10.4"	10.5"
DWHT8-TS6-SS	DWHT8-TS6-316	8"	10"	12.2"	12.3"

Adjustable from 2" to 6" clearance.

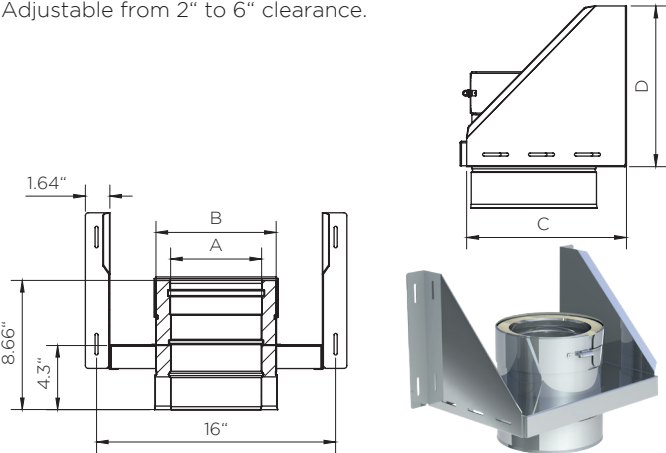

## ADJUSTABLE WALL BRACKET

Provides lateral support for HT Chimney that is installed vertically along a wall. Use every 10 ft.

DESCRIPTION	A
DWHT6-AWB-SS 6" Adjustable Wall Bracket	8"
DWHT8-AWB-SS 8" Adjustable Wall Bracket	10"

Adjustable from 2" to 3" clearance.

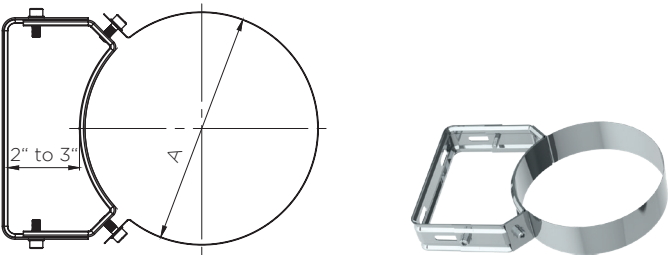

## EXTENDED WALL BRACKET

Provides up to 14" off set clearance for lateral support. Use every 10 ft.

DESCRIPTION	A	B
DWHT6-EWB-SS 6" Extended Wall Bracket	8"	7.6"
DWHT8-EWB-SS 8" Extended Wall Bracket	10"	9.6"

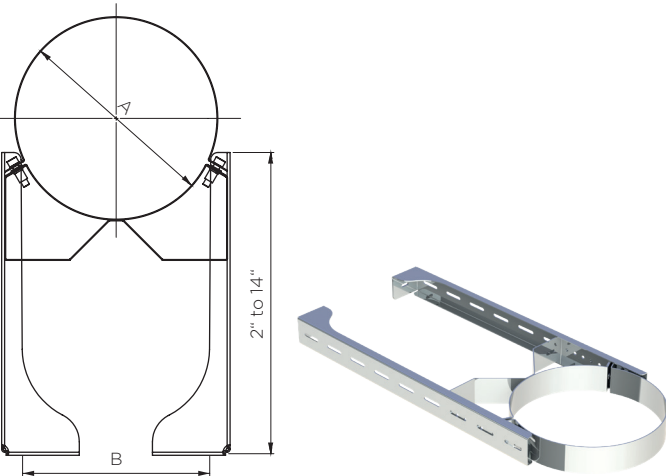

## ELBOW STRAP

Provides support where HT Chimney is offset diagonally. (One Elbow Strap is included with each Elbow Kit).

DESCRIPTION	A
DWHT6-ELS 6" Elbow Strap	8"
DWHT8-ELS 8" Elbow Strap	10"

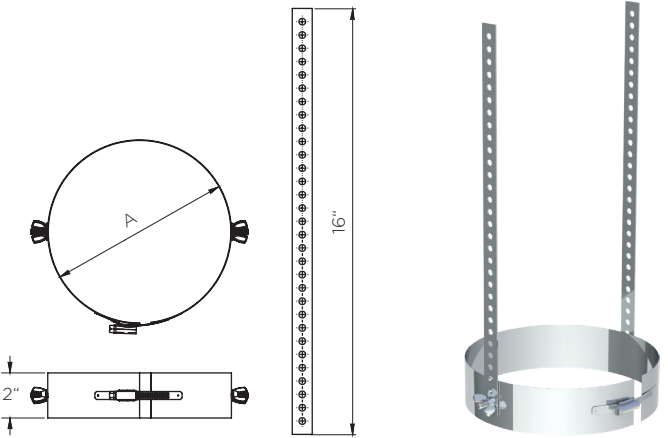





## ATTIC INSULATION SHIELD

Establishes clearance between HT Chimney and Attic insulation. Install where HT Chimney passes through an unoccupied attic space.

DESCRIPTION	A	B	C
DWHT6-IS 6" Attic Insulation Shield	8"	12.2"	16.3"
DWHT8-IS 8" Attic Insulation Shield	10"	14.2"	18.3"

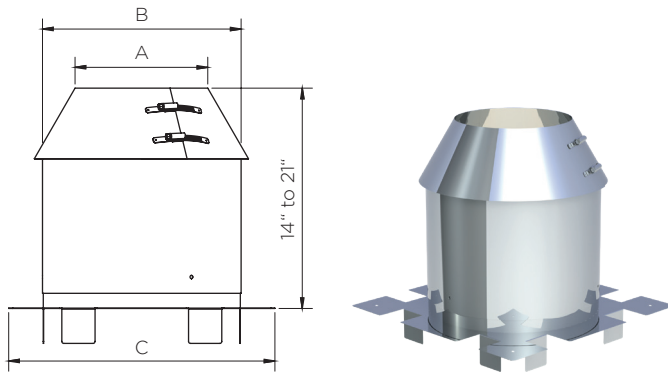

## FIRESTOP RADIATION SHIELD

Installation required where HT Chimney passes through a combustible ceiling or rafters.

DESCRIPTION	A	B	C
DWHT6-FRS 6" Radiation Shield	12"	10"	16.3"
DWHT8-FRS 8" Radiation Shield	14"	12"	18.3"

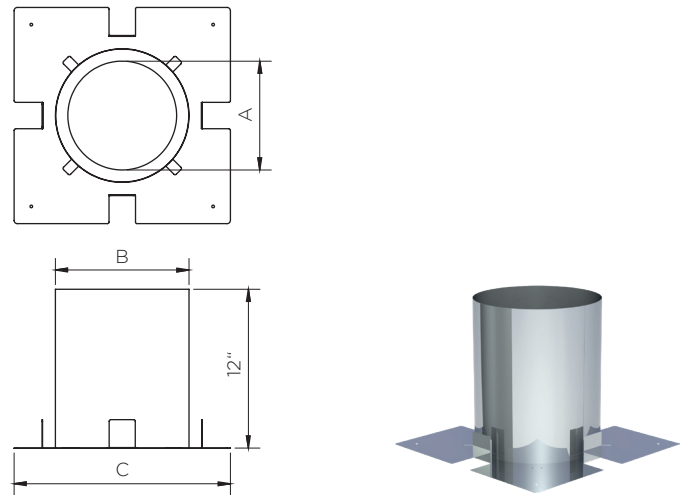

## ROOF TOP FLASHINGS

Flashings are used to seal the opening where the chimney penetrates the roof to divert rain and snow down from the roof and away from the chimney system.

DESCRIPTION	A	B	C	D
DWHT6-FRF-SS 6" Flat Roof Flashing, Stainless Steel	24"	24"	8.5"	8"
DWHT6-PRF06-SS 6" Low Pitch Roof Flashing, Stainless Steel	28.5"	24"	8.5"	6.1"
DWHT6-PRF712-SS 6" High Pitch Roof Flashing, Stainless Steel	30"	24"	8.5"	6.1"
DWHT8-FRF-SS 8" Flat Roof Flashing, Galvanized	28"	28"	10.5"	8"
DWHT8-PRF06-SS 8" Low Pitch Roof Flashing, Galvanized	28.5"	24"	10.5"	6.1"
DWHT8-PRF712-SS 8" High Pitch Roof Flashing, Galvanized	30"	24"	10.5"	6.1"
DWHT6-FRF-GA 6" Flat Roof Flashing, Galvanized	18"	18"	10"	6"
DWHT6-PRF06-GA 6" Low Pitch Roof Flashing, Galvanized	24"	24"	8.75"	4"
DWHT6-PRF712-GA 6" High Pitch Roof Flashing, Galvanized	18.81"	18.81"	8.75"	4"
DWHT6-PRFF06-GA 6" Formable Flashing, Galvanized	38"	38"	8.19"	4"
DWHT8-FRF-GA 8" Flat Roof Flashing, Galvanized	22"	22"	12"	6"
DWHT8-PRF06-GA 8" Low Pitch Roof Flashing, Galvanized	26"	26"	11.25"	4"
DWHT8-PRF712-GA 8" High Pitch Roof Flashing, Galvanized	30"	22"	11.25"	4"
DWHT8-PRFF06-GA 8" Formable Flashing, Galvanized	40"	40"	10.19"	4"

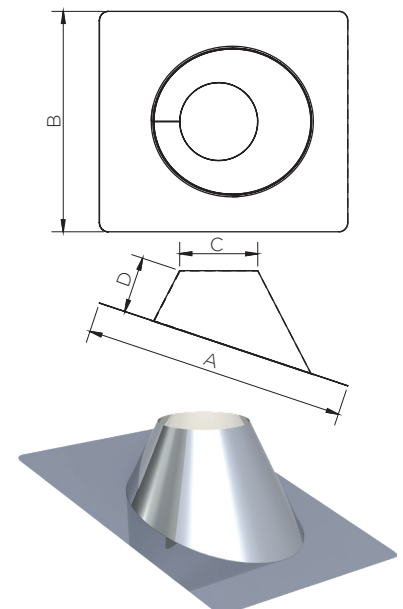

# SYSTEM COMPONENTS

HT 103 CHIMNEYS

## TELESCOPIC ROOF BRACE

Provides for HT Chimney that extends vertically beyond the roof surface.

DESCRIPTION	A
DWHT6-TRB-SS 6" Telescopic Roof Brace	8"
DWHT8-TRB-SS 8" Telescopic Roof Brace	10"

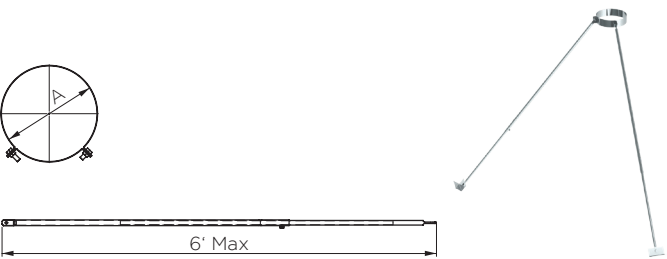

## STORM COLLAR

Installation required where HT Chimney passes through a roof top flashing.

DESCRIPTION	A
DWHT6-SC-SS 6" Storm Collar	8"
DWHT8-SC-SS 8" Storm Collar	10"

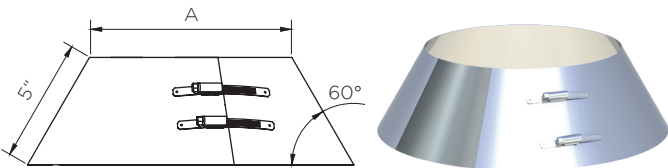

## LOCKING BAND

Used to secure HT Chimney sections together.

DESCRIPTION	A
DWHT6-LB-SS 6" Locking Band 2.0	8"
DWHT8-LB-SS 8" Locking Band 2.0	10"

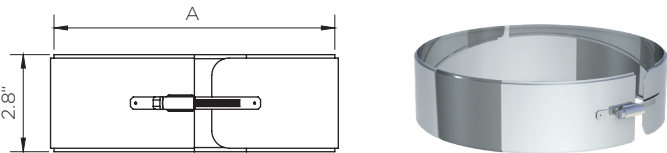

## TEE SUPPORT EXTENDED BRACKET SS

Extends the Tee Support (TS) allowing HT Chimney to be up to 14" from the wall. One size fits all.

DESCRIPTION	A	B
DWHT-TSEB-SS Tee Support Extended Bracket	19"	23.4"

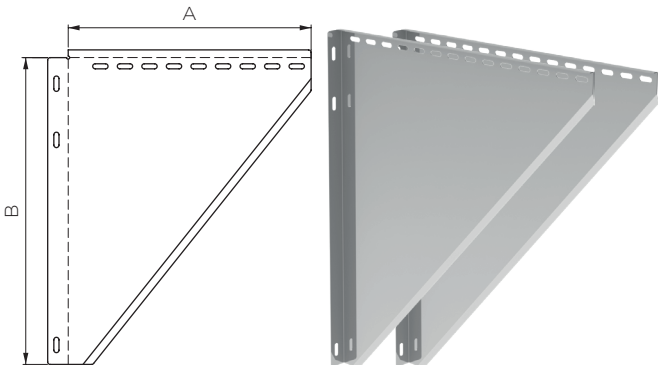



## SPARK ARRESTOR, WELDED WIRE

Prevents birds and other nuisance from entering the HT Chimney. Also reduces ash and other materials from exiting the rain cap. Spark Arrestor is installed inside the Jeremias Crown Cap. One size fits all.

DESCRIPTION
DWHT-SAE-WW Spark Arrestor, Welded Wire

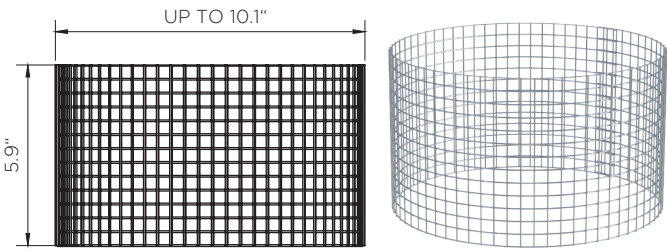

## JEREMIAS CROWN CAP

Terminates the HT Chimney system. Prevents rain from entering the HT Chimney system. Removable top allowing access to the chimney system for cleaning and inspection. Comes installed with a spark arrestor.

DESCRIPTION		A	B	C	D
ITEM (STANDARD)	ITEM (316L INNER)				
DWHT6-JCC-SS	DWHT6-JCC-316	6"	8"	10"	13.5"
DWHT8-JCC-SS	DWHT8-JCC-316	8"	10"	12"	15.5"

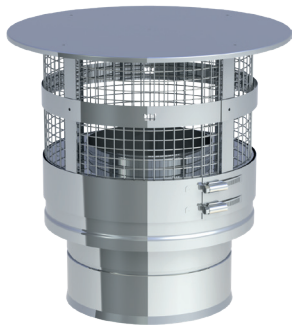
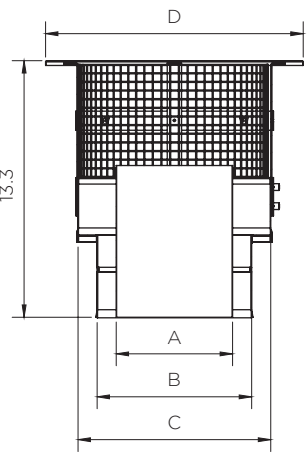

# DWHT ELBOW OFFSET CHART

HT 103 CHIMNEYS

Length Between Offsets	15° Elbows				30° Elbows			
	6"Ø		8"Ø		6"Ø		8"Ø	
	RISE	OFFSET	RISE	OFFSET	RISE	OFFSET	RISE	OFFSET
No Length	10 1/8	11/4	10 5/8	1 3/8	11 5/8	3 1/8	12 5/8	3 3/8
6" Length	13 3/4	2 1/4	14 1/4	2 3/8	14 7/8	5	15 7/8	5 1/4
12" Length	19 1/2	3 3/4	20 1/8	3 7/8	20 1/8	8	21 1/8	8 1/4
18" Length	25 3/8	5 3/8	25 7/8	5 3/8	25 3/8	11	26 3/8	11 1/4
24" Length	31 1/8	6 7/8	31 5/8	7	30 1/2	14	31 1/2	14 1/4
36" Length	42 3/4	10	43 1/4	10 1/8	40 7/8	20	41 7/8	20 1/4
48" Length	54 3/8	13 1/8"	54 7/8	13 1/4	51 1/4	26	52 1/4	26 1/4
48" + 6"	58	14 1/8	58 1/2	14 1/8	54 5/8	27 7/8	55 5/8	28 1/8
48" + 12"	63 3/4	15 5/8	64 3/8	15 3/4	59 3/4	30 7/8	60 3/4	31 1/8
48" + 18"	69 5/8	17 1/4	70 1/8	17 1/4	65	33 7/8	66	34 1/8
48" + 24"	75 3/8	18 3/4	75 7/8	18 7/8	70 1/8	36 7/8	71 1/8	37 1/8
48" + 36"	87	21 7/8	87 1/2	22	80 5/8	42 7/8	81 5/8	43 1/8
48" + 48"	98 5/8	25	99 1/8	25	91	48 7/8	92	49 1/8

All dimensions in inches. Installed rise shown.

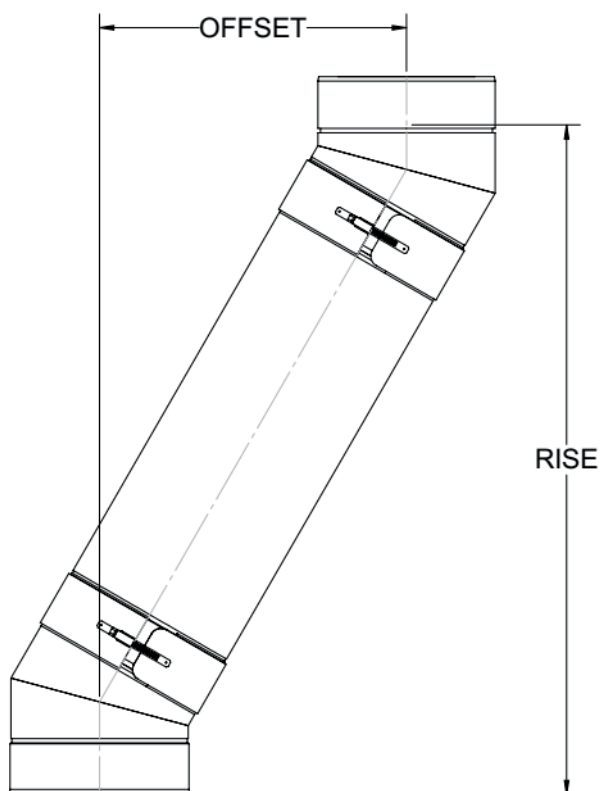



# WARRANTY STATEMENT – UL103HT RATED PRODUCTS



HT 103 CHIMNEYS

## JEREMIAS PRODUCT WARRANTY

Jeremias Inc. ("Jeremias") provides the following Limited Lifetime Warranty (collectively the "Limited Warranty") for products covered by this installation instruction (collectively, the "Products"):

### FOR PRODUCTS PROVEN DEFECTIVE:

- For a period of ten (10) years from the original installation: Jeremias will provide replacement products with similar or like quantity of available Jeremias products, free of charge.
- From the eleventh (11) through fifteen (15) years Jeremias will provide replacement products at a cost of 75% from the Manufacturers Suggested List Price in effect on the date the claim is received.
- From the fifteen (15) year term through 25 years, Jeremias will provide replacement products at a cost of 50% from the Manufacturers Suggested List Price on the date the claim is received.
- Termination caps have a Limited Warranty period of 5 years at 100%.

### LIMITED WARRANTY CONDITIONS:

- Products must have been properly selected, sized, and professionally installed in strict accordance with this installation instruction. For the purposes of this warranty, professional installation would include those with Industry certification (CSIA, NFI, WETT), licensed contractors, or those able to document their installation compliant with this instruction beyond any reasonable doubt.
- Products must be unmodified, and the installation must be compliant and approved with all appliance instructions, and all local and national building codes.
- Products must have documentation of appropriate maintenance, periodic safety inspections and service conducted consistent with this installation instruction.
- Products were at all times operated and maintained in full compliance with Jeremias' operation and maintenance instructions as published at the time of installation.

### EXCLUSION OF LIMITED WARRANTY

The Limited Warranty shall not cover (i) damages to: wear parts, e.g. seals; demonstration units; paintwork; moving parts, including but not limited to compensators, flue gas dampers, draught regulators, doors, minor Product deviations / wear and tear which do not effect safety / functionality; or (ii) damages caused by: contamination of ambient air or combustion air, improper fuel selection including biofuels such as switchgrass / corn, treated lumber, high moisture level (>20%), household trash / garbage, (iii) damages from willful negligence, force majeure including but not limited to flood, fire / frost, acts of God and Nature. This Warranty applies only to Jeremias Inc manufactured products.

## REMEDIES

If a valid Limited Warranty claim arises, Jeremias shall, at its sole discretion, either repair the Product or deliver a properly functioning Product. This Limited Warranty is limited to repair or replacement of the Product plus shipping cost to the location of the defective Product. The Limited Warranty does not cover labor costs for removal or replacement of the defective Product.

## FILING OF A LIMITED WARRANTY CLAIM

If Purchaser believes that there is a justified Limited Warranty claim, Purchaser shall notify Jeremias to that effect in writing. Such notification shall include a description of the defect, original proof of purchase, and all supporting information relating to Conditions and Exclusions above.

## NO OTHER WARRANTY

Except as set forth expressly therein, Jeremias makes no warranties, either express or implied, regarding the products, including but not limited to the implied warranties of merchantability and fitness for a particular purpose. This warranty provides no cash surrender value, and the terms and conditions may not be modified, altered or waived by any action, inaction, or representation except upon the express written authority of an officer of Jeremias.

## DAMAGES DISCLAIMER AND LIMITATION

In no event shall Jeremias be liable to any client or any other person for any (A) Indirect, incidental, consequential or punitive damages, including loss of profit or goodwill or (B) Direct damages to body, health, or property for any matter arising out of or relating to the products, whether such liability is asserted on the basis of contract, tort, or otherwise even if Jeremias has been advised of the possibility of such damages. In no event shall Jeremias' total aggregate liability for damages exceed the greater of the amount of (A) Total compensation paid by purchaser to Jeremias for the products, or (B) Proceeds available from any insurance policy in effect and applicable to the event giving rise to such liability.

## NOTICE

Any notice or other communication hereunder to Jeremias shall be sent postage prepaid, by certified mail, by courier such as United Parcel Service or e-mail, to the following:

Jeremias Inc., 1255 Kennestone Circle, Suite 15, Marietta, GA 30066  
E-mail: [Info@JeremiasInc.com](mailto:Info@JeremiasInc.com).

Notices shall be effective upon receipt.

## TERMS AND CONDITIONS OF SALE

Purchasers' Terms and Conditions of Sale as currently in effect shall govern these Limited Warranties, including without limitation the rights and responsibilities granted hereunder.

Jeremias' Warranty and Terms & Conditions apply.

Visit: <https://jeremiasinc.com>

## NOTES

HT 103 CHIMNEYS

[illegible]

www.jeremiasinc.com | 15

## JEREMIAS GROUP TOTAL QUALITY COMMITMENT

Jeremias is one of the world's leading manufacturers of flue and chimney systems for the exhaust of gases and ventilation, including all kinds of domestic, commercial, and industrial applications.

Our product range includes more than 100 different UL Listed and CE Certified systems covering commercial and industrial applications complemented by freestanding industrial steel chimneys up to 13 feet in diameter.

Jeremias manufactures the highest quality exhaust systems in the world. Our technology and expertise allows for the safest, quietest, and most efficient way to expel exhaust gases to the exterior of buildings.

Opened in 2013, the Jeremias R&D Lab in Logan, OH has the industry's most experienced lab technicians on staff and incorporates the latest equipment technologies. This enables us to provide industry leadership with a focus on new factory-built exhaust applications and unique listings.

## APPROVALS & CERTIFICATIONS



## JEREMIAS IS REPRESENTED IN THE FOLLOWING COUNTRIES:

Austria | Belarus | Belgium | Bulgaria | Brazil | Denmark | Estonia | Hong Kong | Ireland | Kazakhstan | Latvia | Lithuania | Luxembourg | Malta | Netherlands | Norway | Portugal | Romania | Saudi Arabia | Serbia | Singapore | Slovakia | Slovenia | South Africa | Sweden | Tunisia | UAE | Ukraine

Jeremias high quality products to be installed only by selected experts.

The expert in your area:

USA

**Jeremias Inc.**  
1255 Kennestone Circle  
Ste. 150  
Marietta, GA 30066  
Office: +1 678-388-2740  
Fax: +1 678-388-2744  
sales@jeremiasinc.com