

TECHNICAL DATA SHEET

Support Base Plate

SBP



PRODUCT LINE

-SBP, _DCSS, -87ES, -90ES, -87BTS, & -90BTS

PURPOSE

- Installation ease when supporting vertical sections in a Jeremias conical joining system
- The Support Base Plate saves contractor time and money while giving the installation a clean European appearance
- Eliminates the need for an Anchor Plate Support (APS) above the fitting, and the need to support that back to the building structure

APPLICATIONS

- For all KL, FL, GV, & CK variations, diameters, and UL Listings

UL AND ULC LISTINGS

- All applicable UL and ULC Listings for all variations of KL, FL, GV, & CK

-SBP, -DCSS, & -87BTS (OR -90BTS)

-SBP SUPPORT BASE PLATE



MATERIALS

- Supporting tube is typical 0.025" thick 304/430 stainless-steel outer jacket (or inner pipe for single wall applications)
- A 16-gauge 304 stainless-steel square base plate is factory welded to the bottom of the tube

INSTALLATION DETAILS

- Only 1/16" per foot slope is required
- Must be used with accepting Drain Tee Cap Side for Support (DCSS), 89° Elbow for Support (87ES), or 90° Elbow for Support (90ES)
- The installer field cuts the 48" tube to appropriate height allowing the Support Base Plate to support the vertical riser. Greater than 48" lengths are possible on custom orders
- Maximum height above standard 3" through 24" Support Base Plate (SBP) is 50' up to 300' and other diameters are possible on custom orders

FEATURES

- All-stainless with Limited Lifetime warranty
- Cut length available for maximum field flexibility
- Clean and smooth appearance



TECHNICAL DATA SHEET

Support Base Plate

SBP



PRODUCT LINE

-SBP, _DCSS, -87ES, -90ES, -87BTS, & -90BTS

DIMENSIONS

-87ES (OR -90ES) & -SBP

- Standard dimensions used for each component
- Customs are available upon request

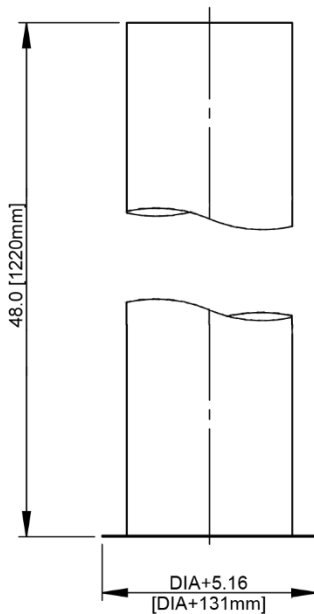

Support with Square Base Plate

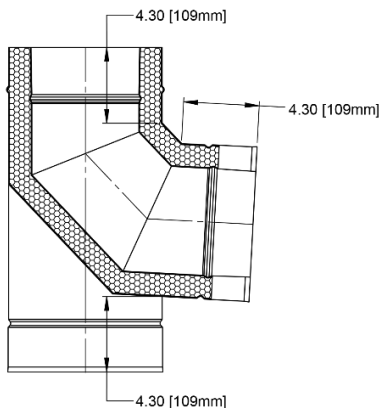

87° Elbow with Support Leg

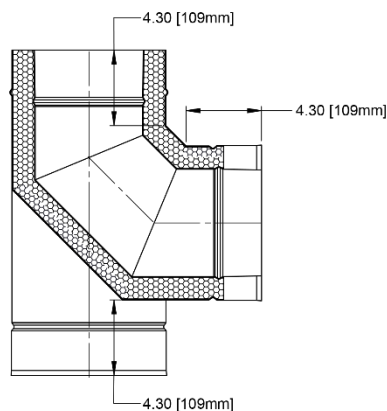

90° Elbow with Support leg

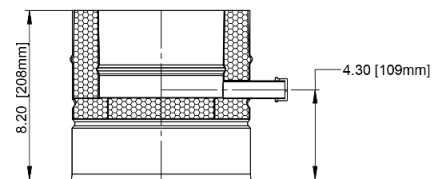

Drain Tee Cap for Support

